

DETAIL A
SECTION C-C
SCALE 1 : 1

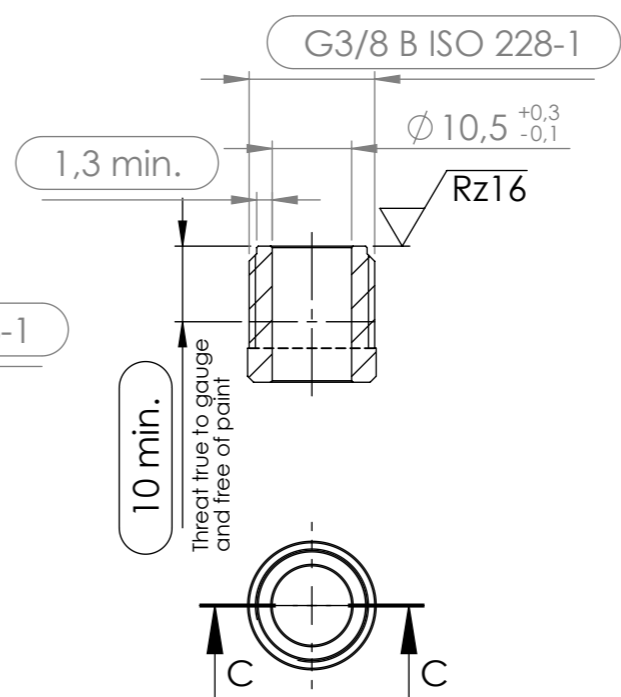

Max operating pressure: 3bar
 Test pressure: 4,5bar
 Max operating temperature: 90°C
 Factory precharge*: 0,75 +0.4 bar
 Nominal volume: 10 litres
 Colour: Silver

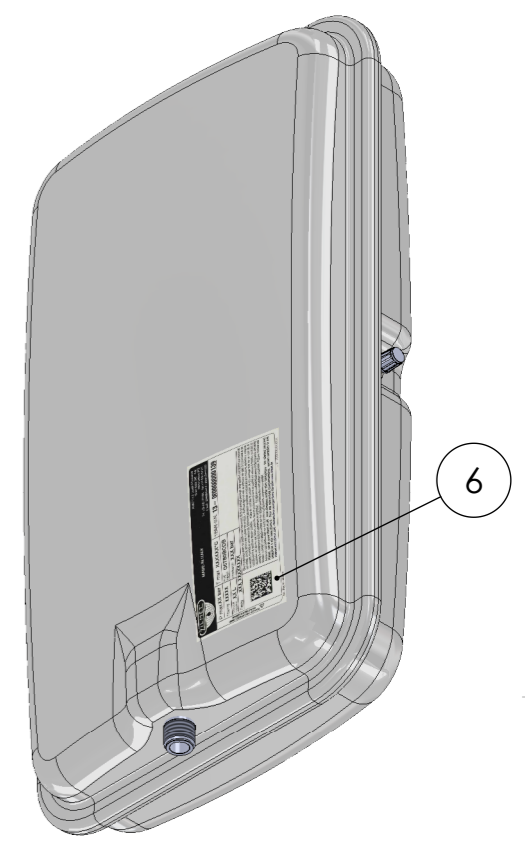

DRAWING FOR APPROVAL
 PLEASE RETURN THIS DRAWING WITH YOUR COMPANY STAMP, SIGNATURE AND DATE. AFTER YOUR APPROVAL WE WILL BE PROCEEDING WITH SUPPLIES AND PRODUCTION.

1	UPPER HEAD	1
2	DOWNER HEAD	1
3	MEMBRANE	1
4	PRECHARGE VALVE	1
5	THREADED NOZZLE	1
6	SELF-ADHESIVE LABEL	1
7	-	-
Pos.	Denomination	Q.ty

Revisioni		
Rev.	Descrizione	Data
02	3D View	12/12/2003
03	Redrawn with SW	20/04/2012
04	Tolerance dimensions; tolerance precharge; added section detail A	26/10/2016

DRAWING N°	SCALE	MATERIAL
539/L	1:4	
*:Tolerance variation bigger/lower than 20% do not compromise the expansion vessel functioning		
DRAWN	DATE	SIGNATURE
	26/10/2016	
CHECKED	DATE	SIGNATURE
	26/10/2016	
APPROVED	DATE	SIGNATURE
	26/10/2016	

DENOMINATION
**EXPANSION VESSEL
10L**

Dimensions in mm

This drawing is the property of company Zilmet S.p.a. All rights reserved.

A3